

Paigaldusjuhend ET-9031 ja ET-9032

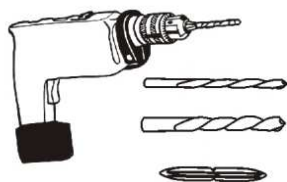

Mõõdud: 90 x 90 x 210 cm
105 x 105 x 210 cm

Vajalikud töövahendid

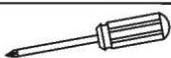
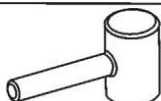
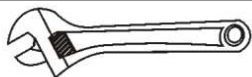
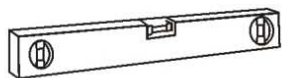

Kaasas olevad seedmed

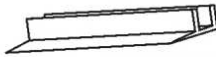
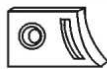
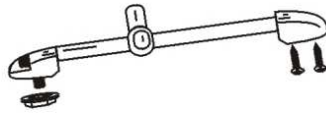
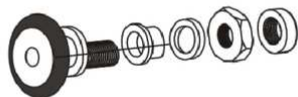
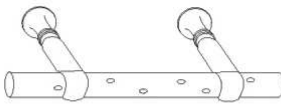
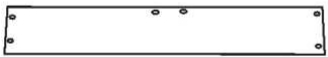
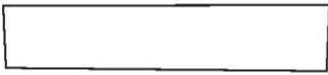
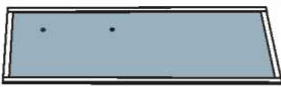
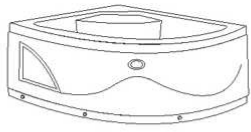

Joonis kuidas paigaldada torusid ja äravoolu



C = külm vesi
H – kuum vesi
D – äravool

Installeerimine

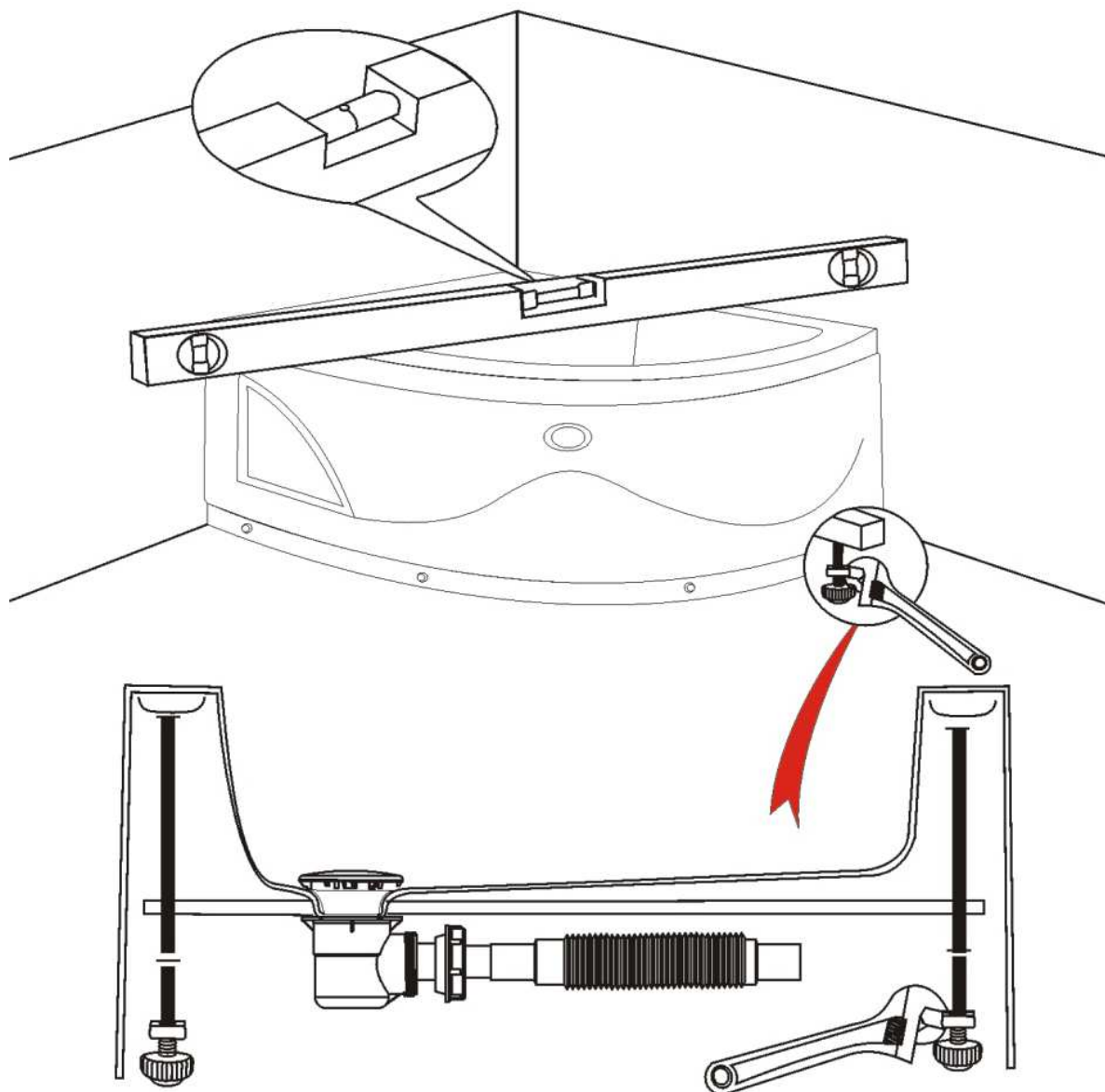

Mõõda loodiga sobiv kõrgus ja reguleeri vastavalt sellele kruvikeerajaga vanni jalad.

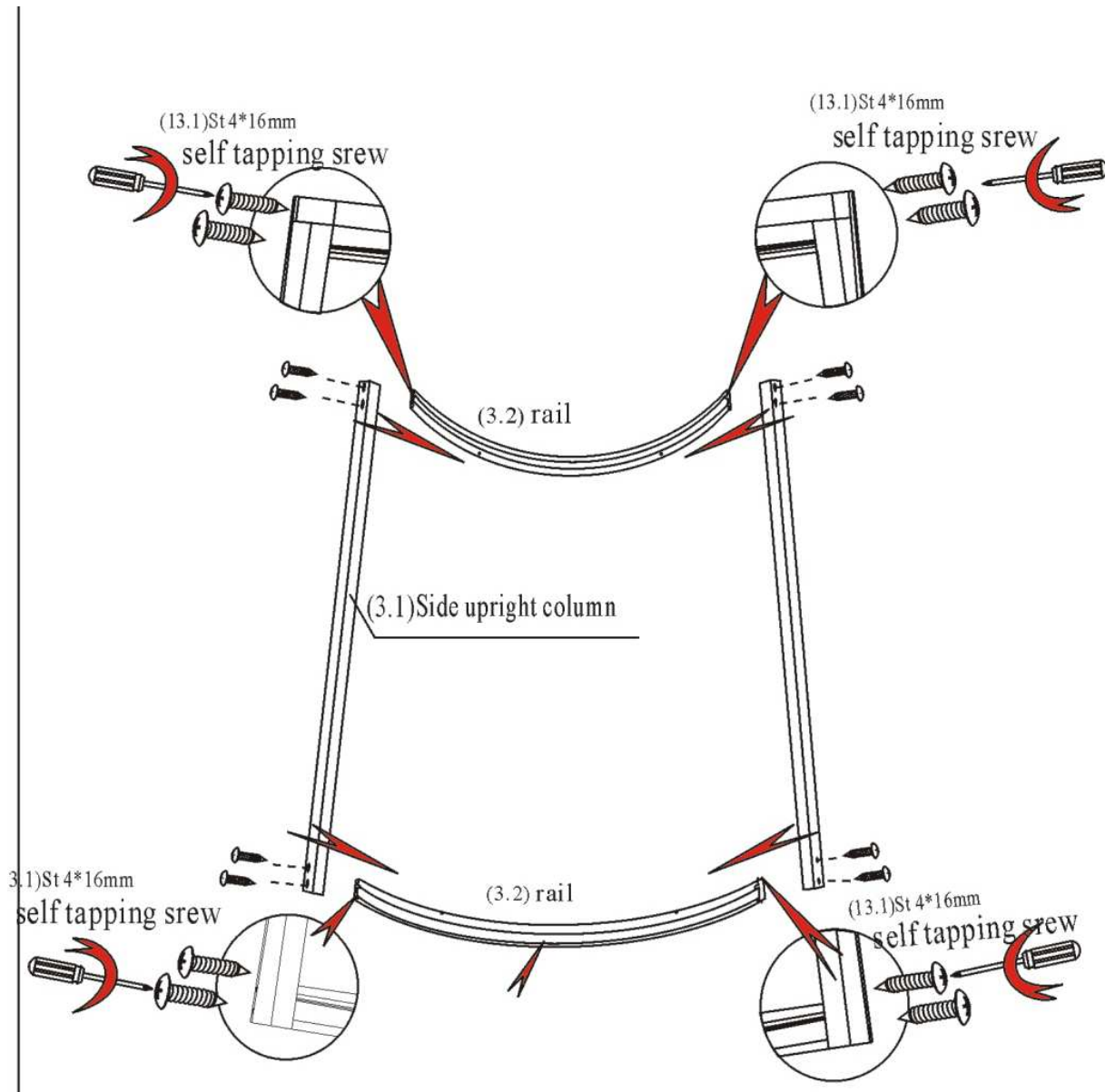
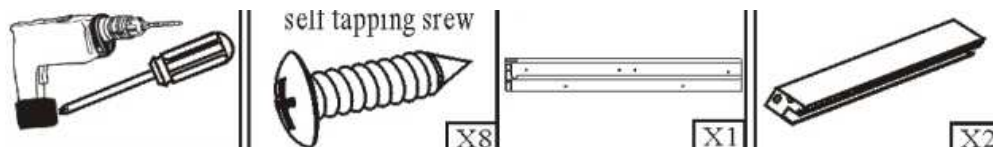

Pange kokku raam, kruvikeeraja ja kruvide abil.

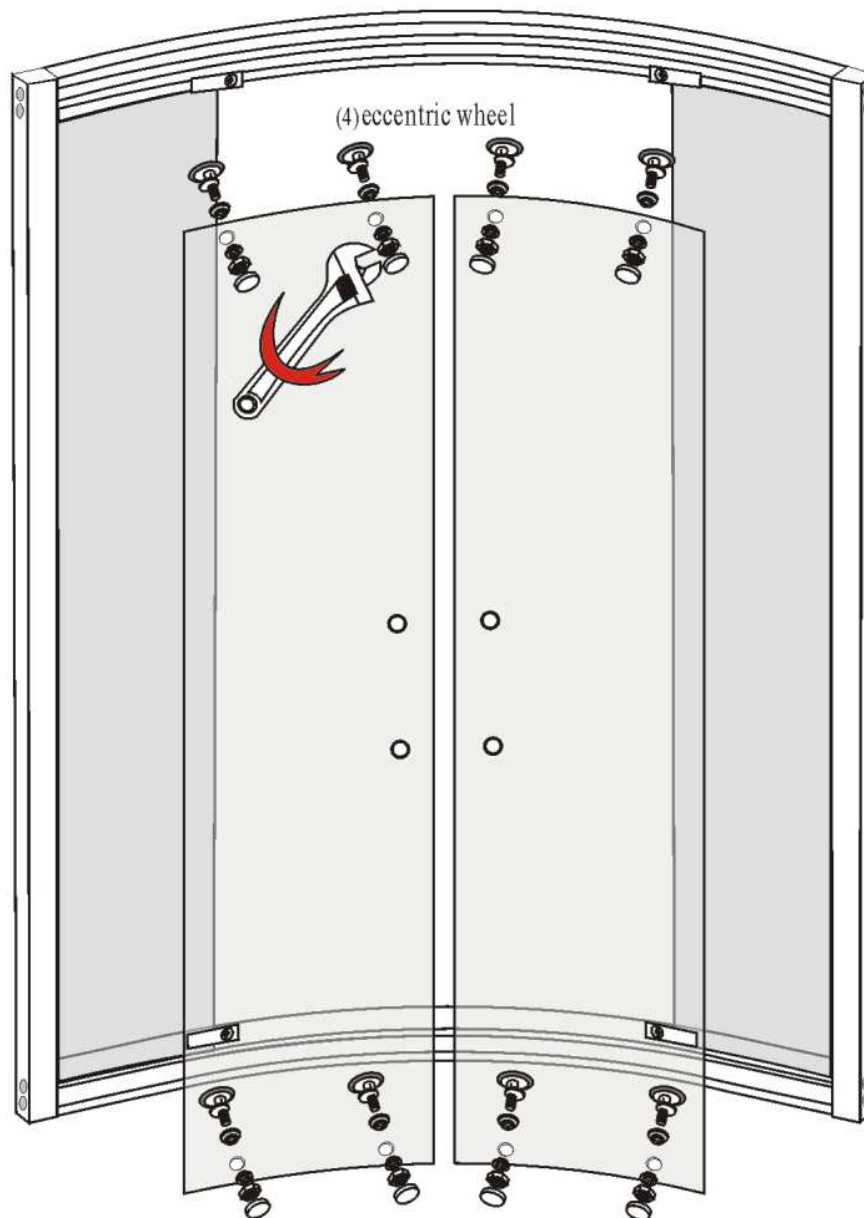

Pane rattad klaas ukse aukudesse ja kohanda kruvikeerajaga.
Seejärel riputage uks üles rööbastele. Kinnitage kõik rattad, veendumaks
et uks liigub sujuvalt.

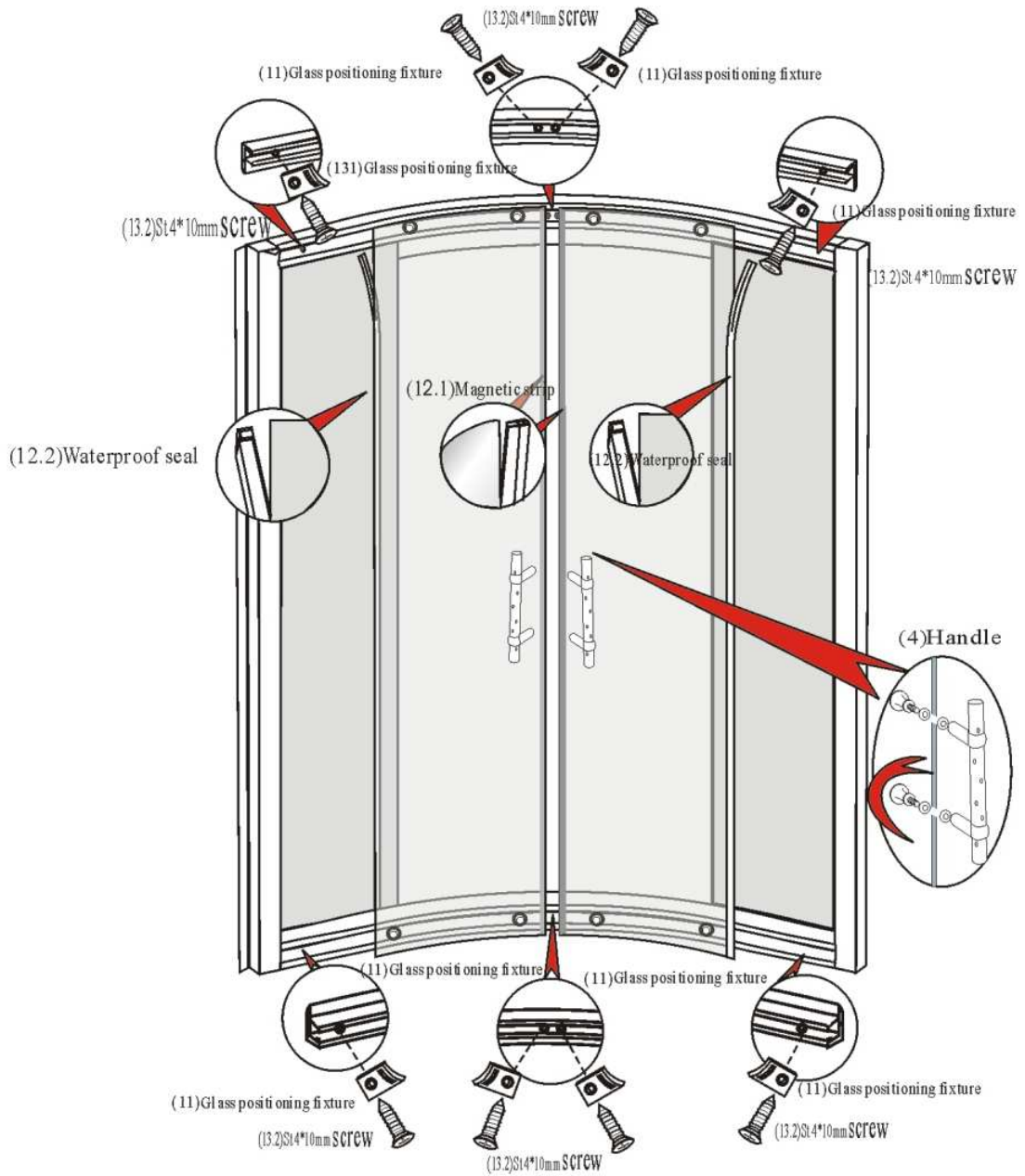
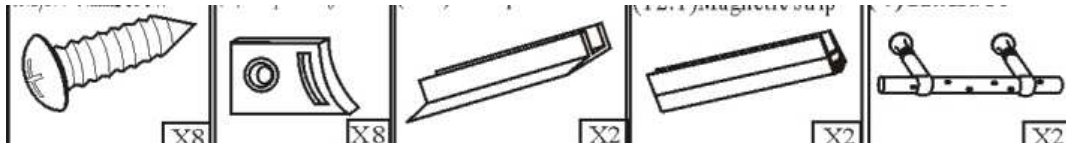

Kinnita käepidemed ukse külge



Kinnita tagaseina ja klaas seinä kruvidega, sobita torustik

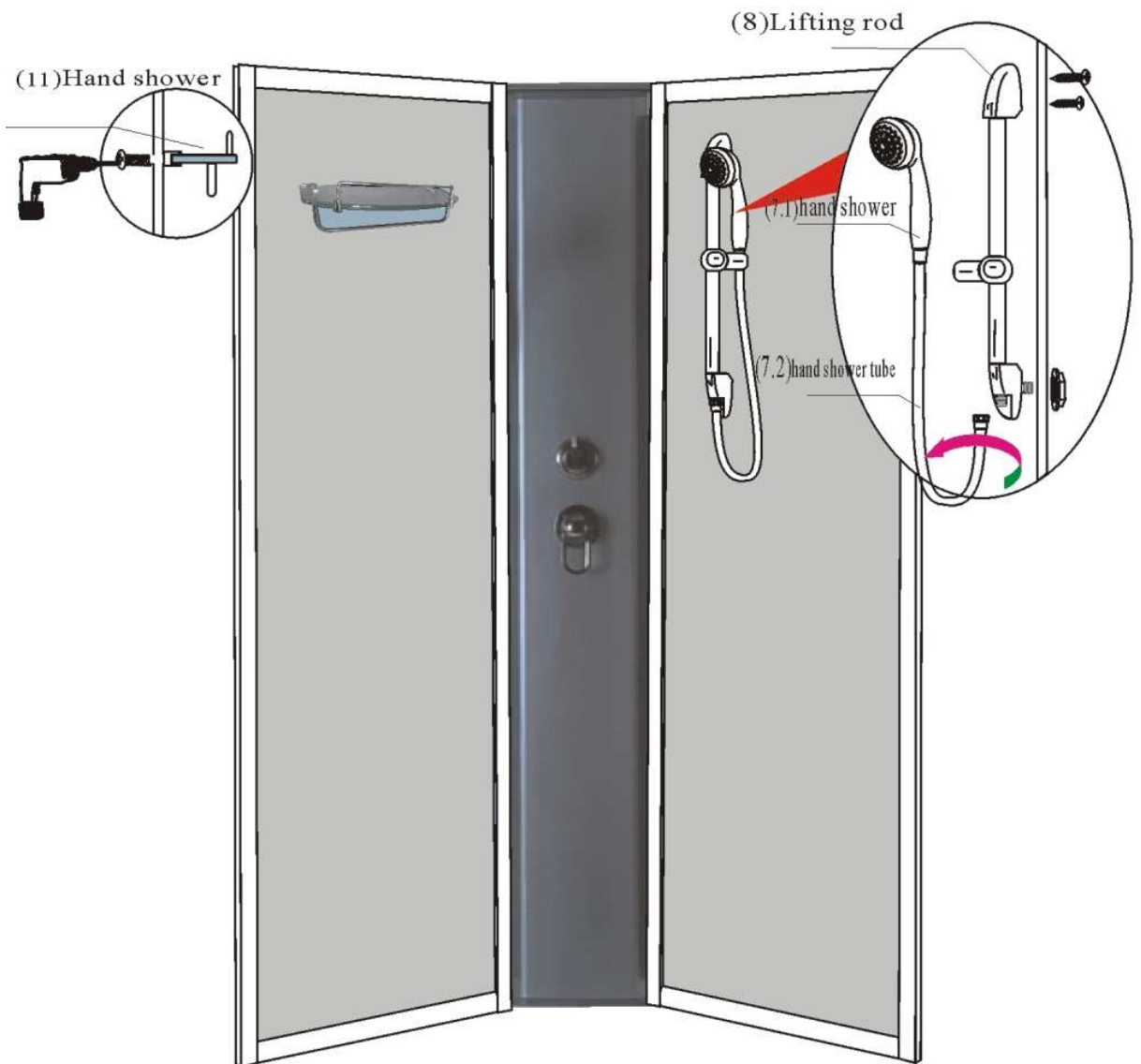
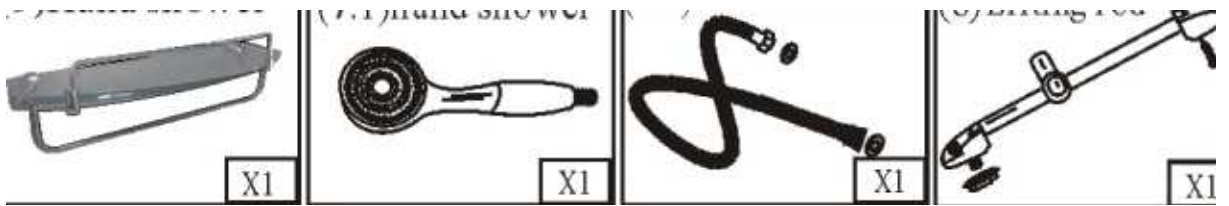

Paigalda seebialus, käsidušš ja klaas riul



Ühenda tagasein ja klaas seinad kruvidega, fikseeri torud

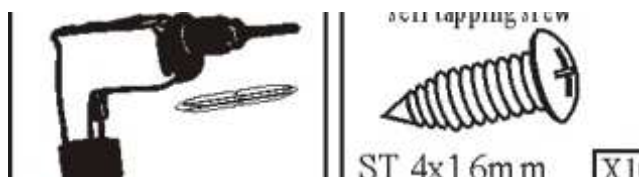

Tõsta kabiini osa vanni peale ja kinnita kruvidega

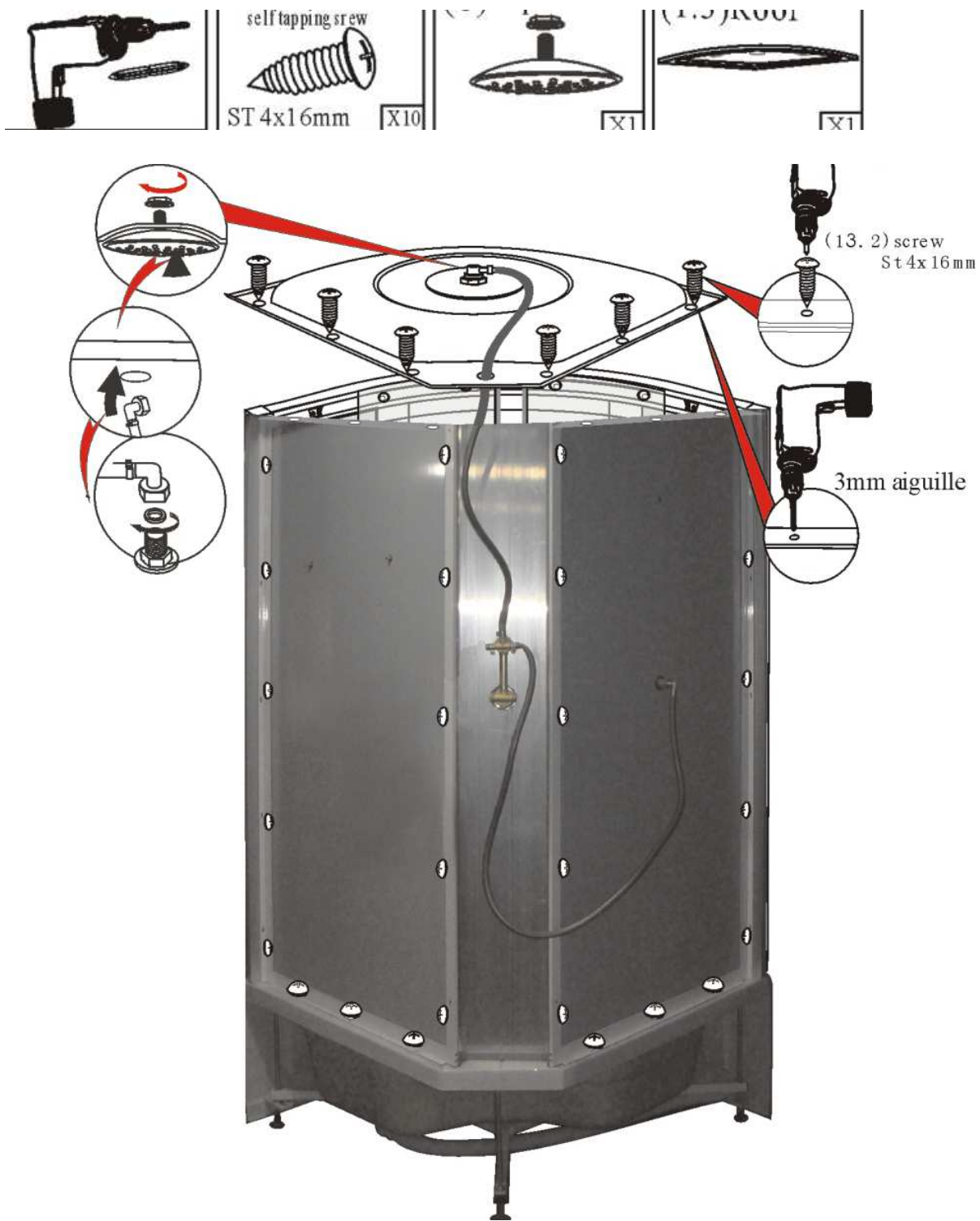

Paigalda kabiinile lagi, fikseerides see 16-ne kruviga. Ühenda kõik torud nii nagu pildil.

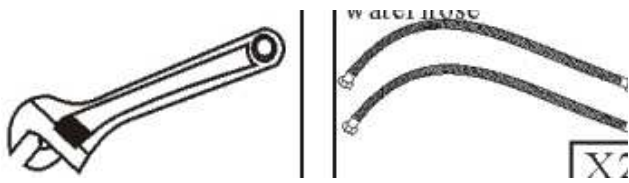

Ühenda külm ja kuum vesi.